

- LEGEND:**
- CONNECT ALL EXIT SIGNS AND BATTERY PACKS IN EMERGENCY LIGHT FIXTURES AHEAD OF ANY LIGHTING CONTROL DEVICE FOR CONTINUOUS OPERATION OF THE BATTERY CHARGER.
  - MEANS OF EGRESS ILLUMINATION LEVEL, INCLUDING STAIRWELLS, SHALL NOT BE LESS THAN 1 FOOTCANDLE AT THE WALKING SURFACE AS REQUIRED BY FBC.

- FIRE ALARM SYMBOL LEGEND:**
- HORN/STROBE WALL MOUNTED WEATHER PROOF, AT 80" AFF TO BOTTOM
- PULL STATION AT 48" AFF TO CENTER

- SYMBOL KEY**
- |       |                              |
|-------|------------------------------|
| B     | OCCUPANCY                    |
| 2,500 | SQUARE FOOTAGE (SQUARE FEET) |
| 1:100 | OCCUPANT LOAD FACTOR         |
| 25    | NUMBER OF OCCUPANTS          |
- 
- |    |                           |
|----|---------------------------|
| 43 | STAIR OPENING CLEAR WIDTH |
| 44 | MAXIMUM CAPACITY (0.3)    |
| 44 | ACTUAL CAPACITY           |
- 
- DIRECTION OF EGRESS AND OCCUPANT LOAD

- WALL TYPES:**
- CONC. BLOCK W/ STUCCO FINISH EXTERIOR AND 5/8" GYP. BD ON 2X2 P.T FURRING
- NON RATED MTL. STUD PARTITION
- 1-HOUR RATED MTL PARTITION
- 1-HOUR RATED MTL PARTITION WITH CONC. FILLED STEEL COLUMN (PROVIDE MASTIC COATING ON EXPOSED -NON PROTECTED STRUCTURAL STEEL PLATES & BASE. APPLICATION PER MANUFACTURER SPECIFICATIONS).
- DOOR DESIGNATION  
REFER TO DOOR SCHEDULE
- WINDOW DESIGNATION  
REFER TO WINDOW SCHEDULE
- DROP SOFFITS G.W.B. SOFFIT AT 8'-4" (U.O.N) A.F.F. WITHIN UNITS AND 8'-4" (U.O.N) A.F.F. BREEZEWAY CORRIDOR, METAL FRAME. REFER TO DETAIL 22/A7.03
- F.E. PROVIDE FIRE EXT. 2A 40BC TYPE (FIRE EXTINGUISHER TO COMPLY W/F.B.C. CHAPTER 36 F.F.P.C. 7.6.3.1 & N.F.P.A 10) MAXIMUM TRAVEL DISTANCE TO A FIRE EXTINGUISHER - 75 FT FOR ORDINARY HAZARD AREAS. FIRE EXTINGUISHERS SHOULD BE MOUNTED MINIMUM 4 INCHES AND MAXIMUM 5FT FROM FLOOR, IF FIRE EXTINGUISHER IS LESS THAN 40LB IN WEIGHT.
- ALL INSULATION MATERIALS TO HAVE A FLAME SPREAD INDEX OF NOT MORE THAN 25 AND A SMOKE-DEVELOPED INDEX OF NOT MORE THAN 450, PER FBC 7th EDITION (2020), SECT 719.2

REVISIONS:	
REV.	REV. ISSUE
1	05/10/2022
2	06/28/2022

**2203**

**GATEWAY LUXURY APARTMENTS**

LOCATED AT:  
950 N POWERLINE ROAD,  
POMPANO BEACH FL 33069

**BURGOS LANZA & ASSOCIATES**  
1246 S ALHAMBRA CIRCLE  
CORPUS CHRISTI, TX 78416  
(786) 558-0935  
AIA 38052898  
WWW.BURGOSLANZA.COM

**BURGOS LANZA ARCHITECTS & PLANNERS**  
AIA 28001519

THESE ARCHITECTURAL DRAWINGS ARE THE LEGAL PROPERTY OF BURGOS LANZA ARCHITECTS AND ARE TO BE USED ONLY FOR THE PROJECT AND SITE SPECIFICALLY IDENTIFIED HEREON. ANY REUSE, REPRODUCTION, OR MODIFICATION OF THESE DRAWINGS WITHOUT THE EXPRESS WRITTEN CONSENT OF THE SAME IS STRICTLY PROHIBITED.

**Pablo Burgos**

Digitally signed by Pablo Burgos  
DN: cn=Pablo Burgos, o=Burgos Lanza & Assoc., ou=AR95925, email=pburgos@burgoslanza.com, c=US  
Date: 2022.06.30 06:24:07 -04'00'

DATE 11/09/21  
DRAWN CR  
PROJECT No. 2203  
SCALE AS-SHOWN

**GROUND FLOOR LIFE SAFETY BUILDING #3**

SCALE: 1/8" = 1'-0"

**LS 31**

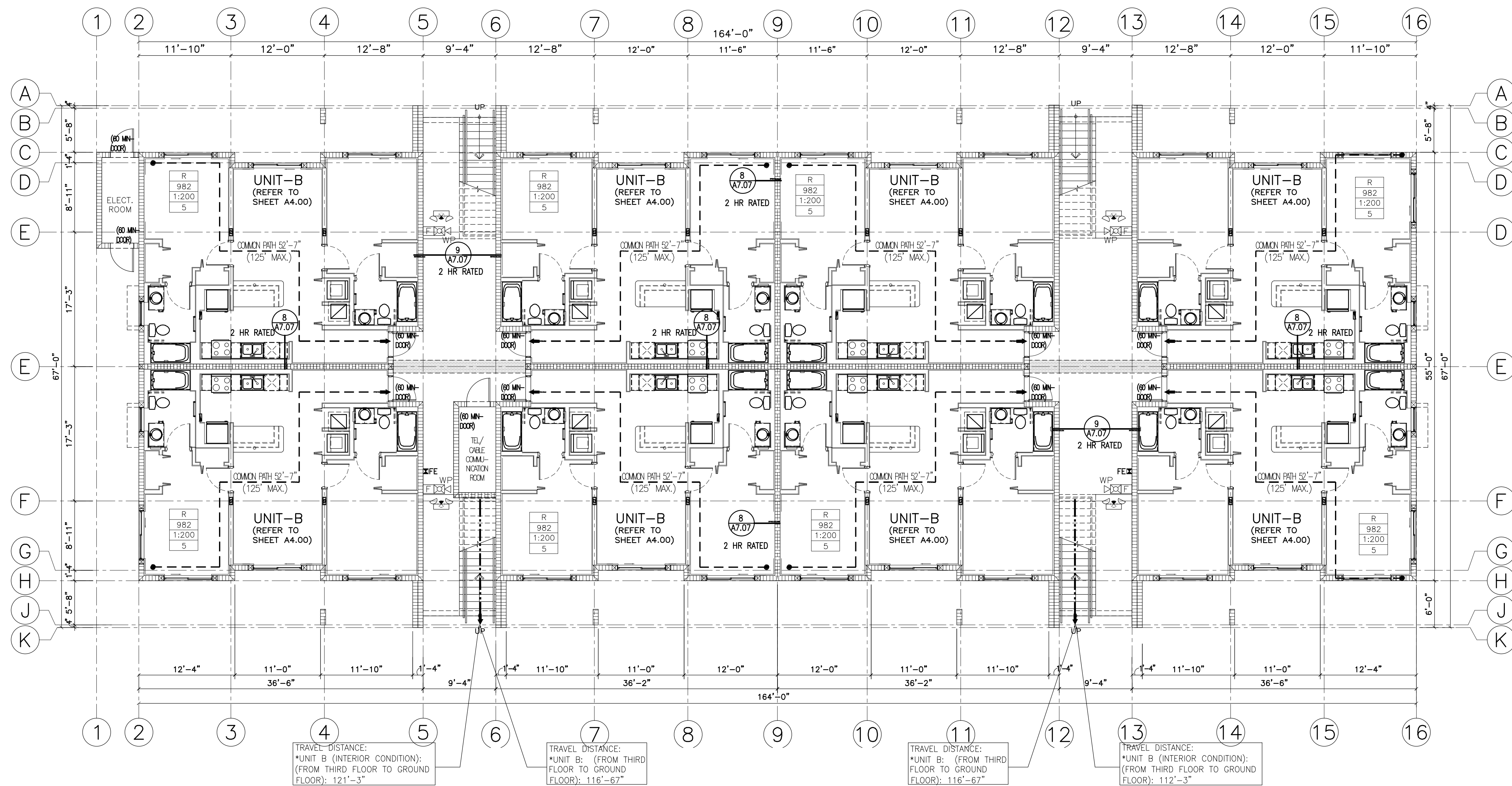

**GROUND FLOOR PLAN - LIFE SAFETY - BUILDING #3**

SCALE: 1/8" = 1'-0"

**DRC**

PZ22-12000008  
8/17/2022